

NOTE:
SEE APPROACH SLAB COMMON DETAILS FOR SECTIONS AND DETAILS NOT SHOWN.

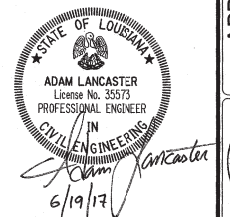

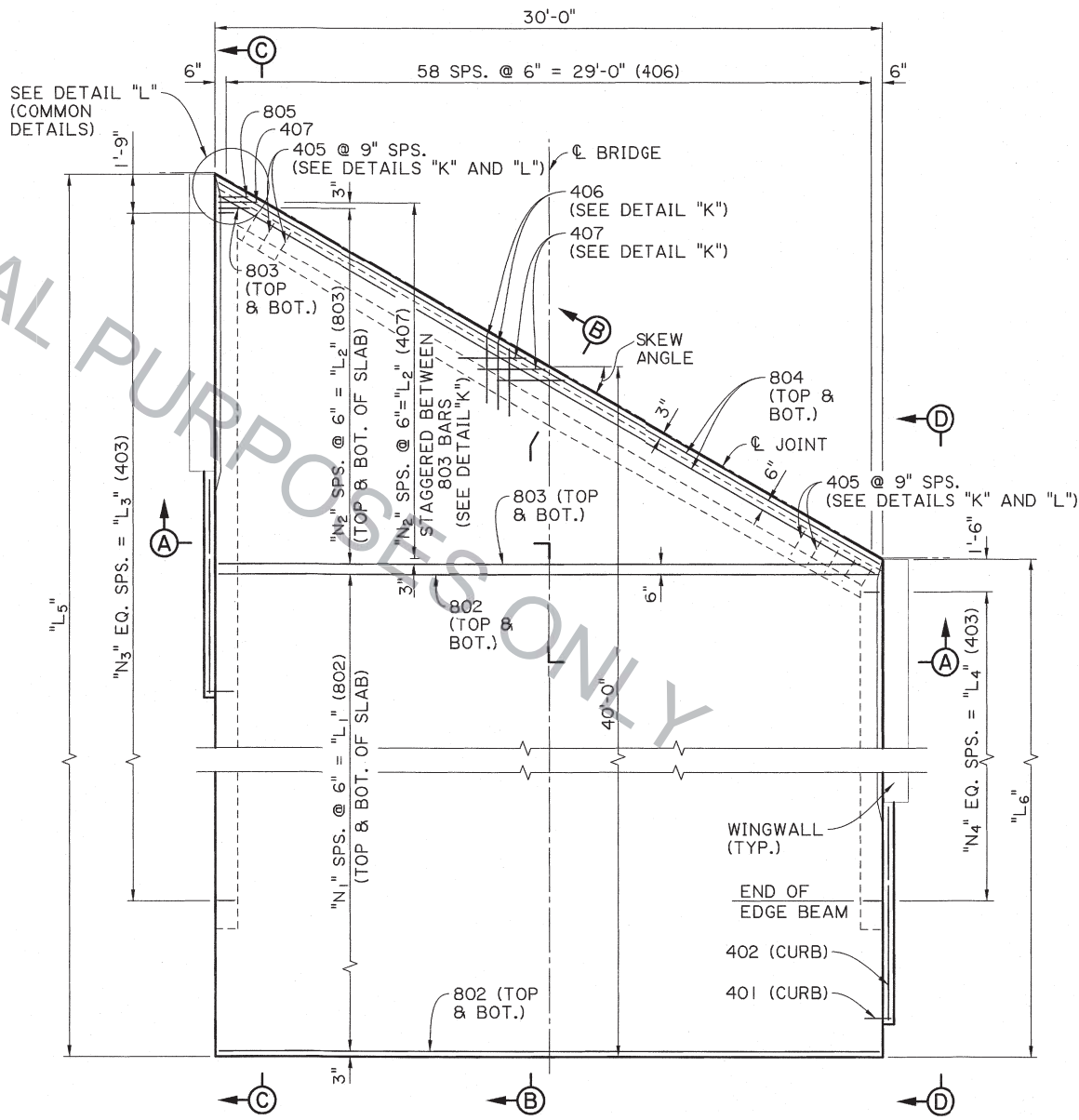

SHEET NUMBER	PARISH	CONTROL SECTION	STATE PROJECT
DESIGNED A. LANCASTER	DESIGNED A. LANCASTER	CHECKED J. W. P.	REVIEWED Z. F. U
CHECKED R. MORVANT	DRAWN J. W. P.	CHECKED A. LANCASTER	SERIES # 1 OF 2
NO.	DATE	BY	REVISION OR CHANGE ORDER DESCRIPTION
<p>APPROACH SLAB DETAILS 40' LONG & 30' CLEAR ROADWAY SLAB SPANS AND QUAD BEAM BRIDGES BD.2.10.2.3.01 - APPROACH SLAB</p>			
<p>BRIDGE AND STRUCTURAL DESIGN</p>			

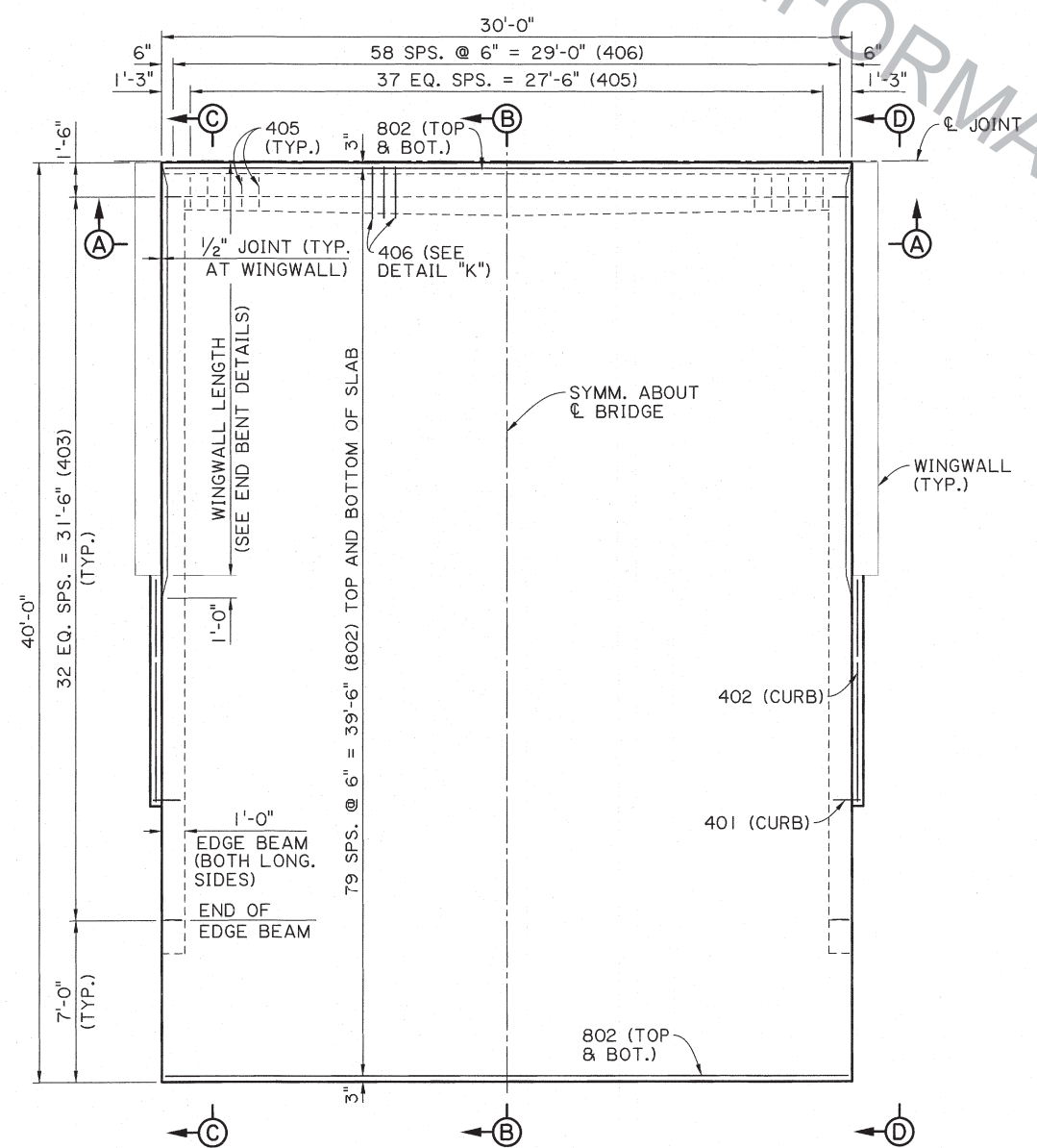
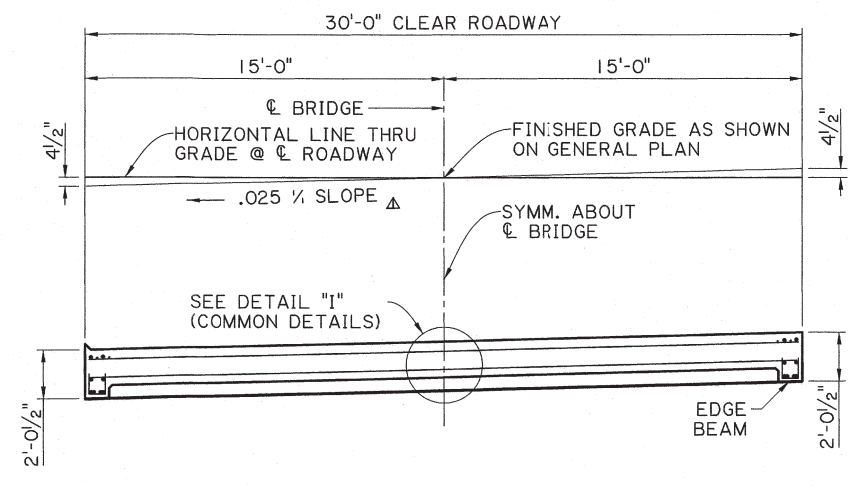
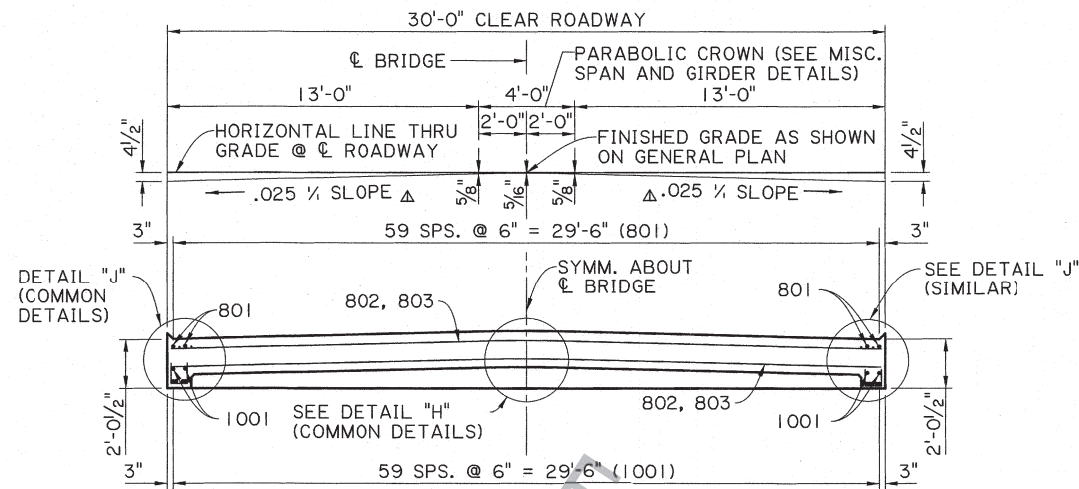

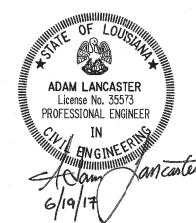
NOTE:
SEE APPROACH SLAB COMMON DETAILS FOR SECTIONS AND DETAILS NOT SHOWN.



SHEET NUMBER	PARISH	DESIGNED	CONTROL	STATE
	A.LANCASTER	A.LANCASTER	A.LANCASTER	LA
	CHECKED	CHECKED	CHECKED	PROJECT
	R. MORVANT	J.W.P.	Z.Z. FU	
				REVISION OR CHANGE ORDER DESCRIPTION
				NO.
				DATE
				BY
 APPROACH SLAB DETAILS 40' LONG & 30' CLEAR ROADWAY GIRDER SPANS EXCLUDING QUAD BEAMS BD.2.10.2.3.03 - APPROACH SLAB				
 BRIDGE AND STRUCTURAL DESIGN				

ESTIMATED QUANTITIES (ONE 0° SKEWED APPROACH SLAB)						
BAR NO.	SHORT BAR	VAR. (IN.)	LONG BAR	TOTAL LENGTH	LOCATION	
1001	60	-	39'-2"	2350'-0"	LONG. IN BOT. OF SLAB	
1002	4	-	32'-4"	129'-4"	BOTTOM OF EDGE BEAMS	
1003	4	-	32'-4"	129'-4"	BOTTOM OF EDGE BEAMS	
-	-	-	-	-	-	
-	-	-	-	-	-	
TOTAL NO. 10 BARS = 2608'-8" = 11,225 LBS.						
801	60	-	39'-2"	2350'-0"	LONG. IN TOP OF SLAB	
802	160	-	29'-8"	4746'-8"	TRANSV. IN TOP & BOT. OF SLAB	
-	-	-	-	-	-	
-	-	-	-	-	-	
-	-	-	-	-	-	
-	-	-	-	-	-	
-	-	-	-	-	-	
TOTAL NO. 8 BARS = 7096'-8" = 18,948 LBS.						
501	14	-	29'-8"	415'-4"	TOP & BOT. OF SLEEPER SLAB	
502	80	-	4'-8"	373'-4"	TOP & BOT. OF SLEEPER SLAB	
TOTAL NO. 5 BARS = 788'-8" = 823 LBS.						
401	22	-	1'-10"	40'-4"	DOWELS IN CURBS	
402	2	-	13'-1"	26'-2"	LONG. IN CURBS	
403	66	-	2'-2"	143'-0"	STIRRUPS IN EDGE BEAMS	
404	2	-	29'-8"	59'-4"	BOTTOM OF HAUNCH	
405	38	-	4'-8"	177'-4"	STIRRUPS IN HAUNCH	
406	59	-	3'-1"	181'-11"	LONG. IN TOP OF SLAB	
-	-	-	-	-	-	
TOTAL NO. 4 BARS = 628'-1" = 420 LBS.						
TOTAL DEFORMED REINFORCING STEEL					31,416 LBS.	
CONCRETE APPROACH SLAB					1,200 SQ. FT.	

ESTIMATED QUANTITIES (ONE 30° SKEWED APPROACH SLAB)						
BAR NO.	SHORT BAR	VAR. (IN.)	LONG BAR	TOTAL LENGTH	LOCATION	
1001	60	30'-6"	3.46"	47'-6"	LONG. IN BOT. OF SLAB	
1002	4	-	-	40'-5"	BOTTOM OF EDGE BEAMS	
1003	4	-	-	23'-8"	BOTTOM OF EDGE BEAMS	
-	-	-	-	-	-	
-	-	-	-	-	-	
TOTAL NO. 10 BARS = 2596'-4" = 11,172 LBS.						
801	60	30'-6"	3.46"	47'-6"	LONG. IN TOP OF SLAB	
802	122	-	-	29'-8"	TRANSV. IN TOP & BOT. OF SLAB	
803	66	1'-8"	10.44"	29'-6"	TRANSV. IN TOP & BOT. OF SLAB	
804	4	-	-	34'-3"	TOP & BOT. OF SLAB ALONG SKEW	
805	4	-	-	1'-6"	CORNER OF SLAB	
-	-	-	-	-	-	
-	-	-	-	-	-	
TOTAL NO. 8 BARS = 7130'-10" = 19,039 LBS.						
501	14	-	-	29'-8"	TOP & BOT. OF SLEEPER SLAB	
502	80	-	-	4'-8"	TOP & BOT. OF SLEEPER SLAB	
TOTAL NO. 5 BARS = 788'-8" = 823 LBS.						
401	22	-	-	1'-10"	DOWELS IN CURB	
402	2	-	-	13'-1"	LONG. IN CURB	
403	65	-	-	2'-2"	STIRRUPS IN EDGE BEAMS	
404	2	-	-	34'-3"	BOTTOM OF HAUNCH	
405	43	-	-	4'-8"	STIRRUPS IN HAUNCH	
406	59	-	-	3'-1"	LONG. IN TOP OF SLAB	
407	33	-	-	2'-0"	TRANSV. IN TOP OF SLAB	
TOTAL NO. 4 BARS = 724'-5" = 484 LBS.						
TOTAL DEFORMED REINFORCING STEEL					31,518 LBS.	
CONCRETE APPROACH SLAB					1,200 SQ. FT.	

ESTIMATED QUANTITIES (ONE 15° SKEWED APPROACH SLAB)						
BAR NO.	SHORT BAR	VAR. (IN.)	LONG BAR	TOTAL LENGTH	LOCATION	
1001	60	35'-2"	1.61"	43'-1"	LONG. IN BOT. OF SLAB	
1002	4	-	-	36'-1"	BOTTOM OF EDGE BEAMS	
1003	4	-	-	28'-4"	BOTTOM OF EDGE BEAMS	
-	-	-	-	-	-	
-	-	-	-	-	-	
TOTAL NO. 10 BARS = 2605'-2" = 11,210 LBS.						
801	60	35'-2"	1.61"	43'-1"	LONG. IN TOP OF SLAB	
802	142	-	-	29'-8"	TRANSV. IN TOP & BOT. OF SLAB	
803	30	2'-0"	22.36"	28'-1"	TRANSV. IN TOP & BOT. OF SLAB	
804	4	-	-	30'-8"	TOP & BOT. OF SLAB ALONG SKEW	
805	2	-	-	1'-6"	CORNER OF SLAB	
-	-	-	-	-	-	
-	-	-	-	-	-	
TOTAL NO. 8 BARS = 7137'-1" = 19,056 LBS.						
501	14	-	-	29'-8"	TOP & BOT. OF SLEEPER SLAB	
502	80	-	-	4'-6"	TOP & BOT. OF SLEEPER SLAB	
TOTAL NO. 5 BARS = 788'-8" = 823 LBS.						
401	22	-	-	1'-10"	DOWELS IN CURB	
402	2	-	-	13'-1"	LONG. IN CURB	
403	66	-	-	2'-2"	STIRRUPS IN EDGE BEAMS	
404	2	-	-	30'-8"	BOTTOM OF HAUNCH	
405	39	-	-	4'-8"	STIRRUPS IN HAUNCH	
406	59	-	-	3'-1"	LONG. IN TOP OF SLAB	
407	15	-	-	3'-0"	TRANSV. IN TOP OF SLAB	
TOTAL NO. 4 BARS = 679'-9" = 454 LBS.						
TOTAL DEFORMED REINFORCING STEEL					31,543 LBS.	
CONCRETE APPROACH SLAB					1,200 SQ. FT.	

ESTIMATED QUANTITIES (ONE 45° SKEWED APPROACH SLAB)						
BAR NO.	SHORT BAR	VAR. (IN.)	LONG BAR	TOTAL LENGTH	LOCATION	
1001	60	24'-1"	6.0"	53'-7"	LONG. IN BOT. OF SLAB	
1002	4	-	-	46'-4"	BOTTOM OF EDGE BEAMS	
1003	4	-	-	17'-4"	BOTTOM OF EDGE BEAMS	
-	-	-	-	-	-	
-	-	-	-	-	-	
TOTAL NO. 10 BARS = 2584'-8" = 11,122 LBS.						
801	60	24'-1"	6.0"	53'-7"	LONG. IN TOP OF SLAB	
802	96	-	-	29'-8"	TRANSV. IN TOP & BOT. OF SLAB	
803	114	1'-7"	6.0"	29'-7"	TRANSV. IN TOP & BOT. OF SLAB	
804	4	-	-	41'-11"	TOP & BOT. OF SLAB ALONG SKEW	
805	6	-	-	1'-6"	CORNER OF SLAB	
-	-	-	-	-	-	
-	-	-	-	-	-	
TOTAL NO. 8 BARS = 7131'-2" = 19,040 LBS.						
501	14	-	-	29'-8"	TOP & BOT. OF SLEEPER SLAB	
502	80	-	-	4'-8"	TOP & BOT. OF SLEEPER SLAB	
TOTAL NO. 5 BARS = 788'-8" = 823 LBS.						
401	22	-	-	1'-10"	DOWELS IN CURB	
402	2	-	-	13'-1"	LONG. IN CURB	
403	66	-	-	2'-2"	STIRRUPS IN EDGE BEAMS	
404	2	-	-	43'-8"	BOTTOM OF HAUNCH	
405	53	-	-	4'-8"	STIRRUPS IN HAUNCH	
406	59	-	-	3'-1"	LONG. IN TOP OF SLAB	
407	57	-	-	2'-0"	TRANSV. IN TOP OF SLAB	
TOTAL NO. 4 BARS = 840'-1" = 561 LBS.						
TOTAL DEFORMED REINFORCING STEEL					31,546 LBS.	
CONCRETE APPROACH SLAB					1,200 SQ. FT.	

NOTES:

- 1. QUANTITIES SHOWN FOR 401 AND 402 BARS ARE FOR A 13'-6" CURB (SEE APPROACH SLAB DETAIL "Q"). ADJUST QUANTITIES AS NEEDED FOR LONGER CURBS OR FOR "BRIDGE END DRAIN SYSTEM" INSTALLATIONS. BRIDGES WITHOUT GUARDRAIL OR END DRAINS DO NOT REQUIRE A CURB, UNLESS OTHERWISE STATED IN THE PLANS.
- 2. ALL MATERIAL TO BE PAID FOR UNDER ITEM "CONCRETE APPROACH SLABS (CAST-IN-PLACE)." QUANTITIES ARE FOR INFORMATION PURPOSES ONLY.
- 3. FOR HANDLING PURPOSES, #4 BARS OVER 40' MAY BE SPLICED WITH A 1'-9" MIN. LAP SPLICE. ALL SPLICES TO BE STAGGERED. (1'-9" SPLICE INCLUDED IN ESTIMATED QUANTITIES.)

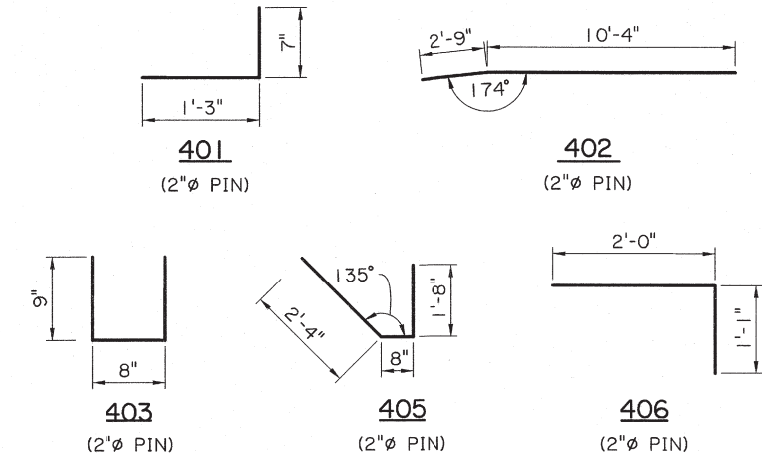

VARIABLES (SEE PLAN VIEW, SHT. 1 OF 2)			
VARIABLE	15° SKEW	30° SKEW	45° SKEW
N ₁	70	60	47
N ₂	14	32	56
N ₃	36	40	47
N ₄	28	23	17
L ₁	35'-0"	30'-0"	23'-6"
L ₂	7'-0"	16'-0"	28'-0"
L ₃	35'-3"	39'-11"	46'-3"
L ₄	27'-6"	22'-10"	16'-6"
L ₅	44'-0 1/4"	48'-8"	55'-0"
L ₆	35'-11 3/4"	31'-4"	25'-0"

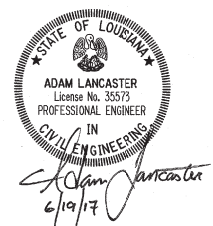
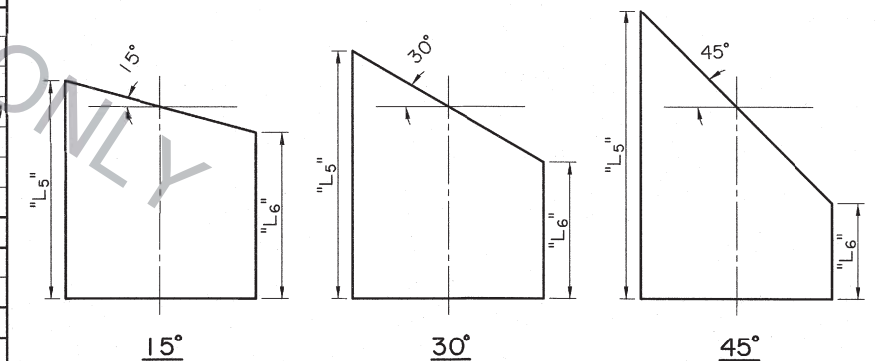

SHEET NUMBER	DESIGNED A. LANCASTER	CHECKED R. MORVANT	PARISH
SECTION	CONTROL	CONTROL	CONTROL
PROJECT	REVIEWED Z.Z. FU	STATE	STATE
NO.	SERIES # 2 OF 2	BY	BY
DATE	REVISION OR CHANGE ORDER DESCRIPTION	DATE	DATE
APPROACH SLAB QUANTITIES 40' LONG & 30' CLEAR ROADWAY GIRDER SPANS EXCLUDING QUAD BEAMS BD.2.10.2.3.04 - APPROACH SLAB			
BRIDGE AND STRUCTURAL DESIGN			